

LEGAL

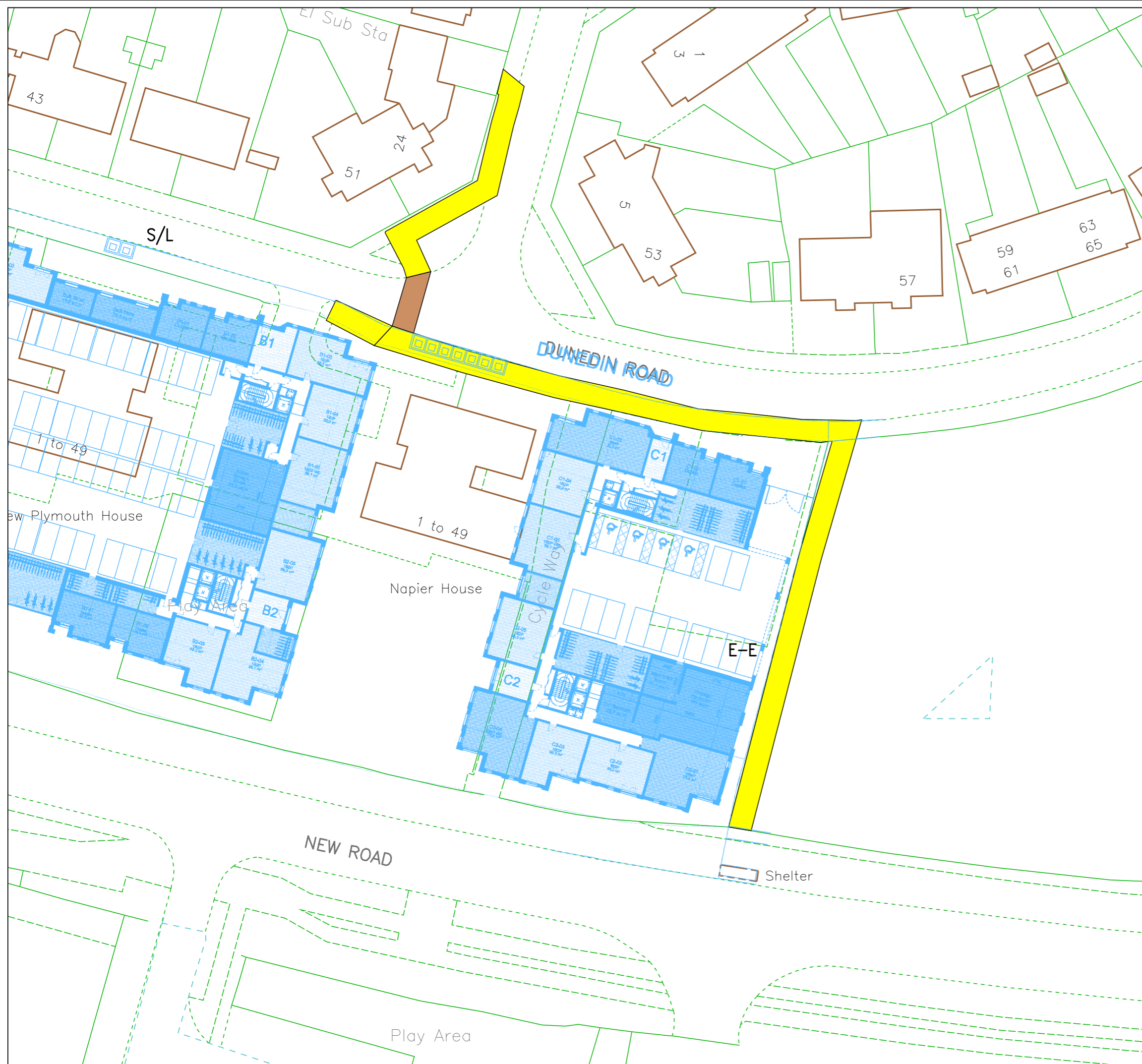

| Legend                             |  |
|------------------------------------|--|
| Land to be ACQUIRED .....          |  |
| Land to be RETAINED .....          |  |
| Land for DISPOSAL .....            |  |
| ACCESS for PLANT & PERSONNEL ..... |  |
| CABLE RIGHTS ONLY.....             |  |
| ACCESS & CABLE RIGHTS.....         |  |
| ACCESS & EQUIPMENT RIGHTS          |  |
| <b>Proposed</b>                    |  |
| OVERHEAD LINE – HV                 |  |
| OVERHEAD LINE – LV                 |  |
| TOWER                              |  |
| H-POLE                             |  |
| POLE(S)                            |  |
| STAY(S)                            |  |
| STRUT(S)                           |  |

Dunedin Road RM13 8LD  
 8500106201  
 Plotted On: 16/07/2019 Map Centre : TQ 5178 8264  
 Scale : 1:500 (When plotted at A3) Drawn by : Allison Ring

Reproduced by permission of Ordnance Survey on behalf of HMSO. (c) Crown copyright and database right 2019. All rights reserved. Ordnance Survey Licence number 100019626. Data has been added to the Ordnance Survey base map; all proprietary rights in such additional data are and shall remain the exclusive property of (c) Eastern Power Networks plc or London Power Networks plc each being a distribution licensee under section 6(1)(c) of the Electricity Act 1989 for the relevant distribution services area as that term is defined in such licensee's distribution licence. All rights in such data reserved.